

a 60 33

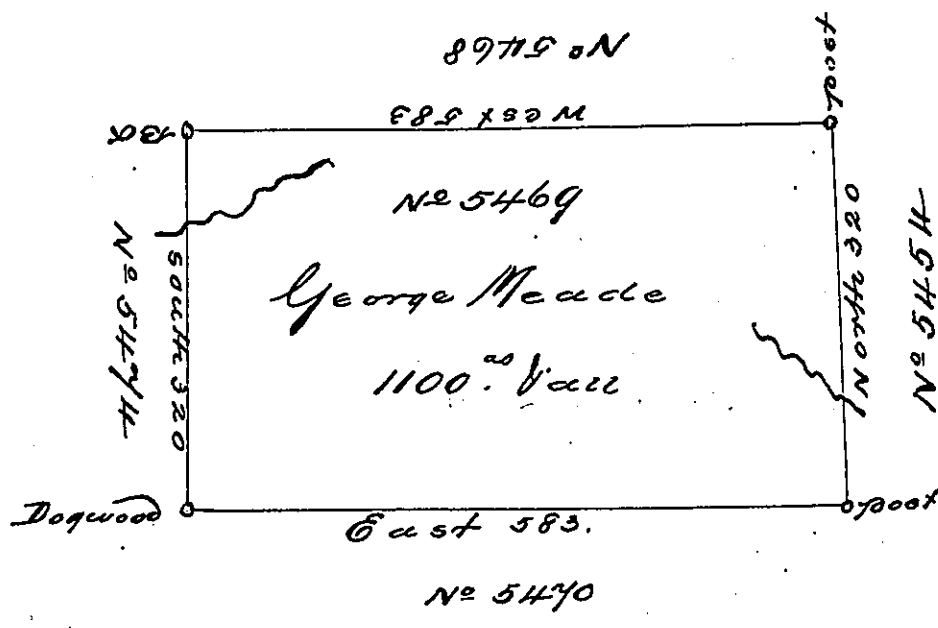

a 60 259

I, Meade, on the waters of Sinnemahoning Creek in Northern County, containing 1100 acres and the usual Allowance for Roads - Surveyed May 9th, 1794, for George Meade in pursuance of a Warrant No 5169, dated 3^d March, 1794.

Daniel Broadhead Esqr
J.G.

John Canan, D. J.

IN TESTIMONY that the above is a copy of the original remaining on file in the Department of Internal Affairs of Pennsylvania, made conformably to an Act of Assembly approved the 16th day of February, 1833, I have hereunto set my Hand and caused the Seal of said Department to be affixed at Harrisburg, this seventh day of November, 1899,

James W. Latta
Secretary of Internal Affairs.